

# T-BOLT BAND CLAMPS

## Marine Grade Clamps



### Corrosion Safeguard

Clampco Products manufactures and stocks Marine Grade 316 Stainless Steel T-Bolt Band Clamps. The 316 T-bolt band clamps offer better corrosion resistance than the standard 301, 302, and 304 T-bolt band clamps. Because 316 stainless steel performs well in saltwater applications, 316 T-bolt band clamps are commonly installed on marine engine and exhaust systems. Other typical applications include water treatment and sewage systems, pool filters, telecommunication devices, and food and pharmaceutical processing equipment.

Clampco currently stocks the following Marine Grade 316 Stainless Steel T-Bolt Band Clamps. Other sizes and styles are available upon customer request. Add electro polish finishing for additional corrosion resistance.

**941YL Series**  
Band Width = 0.75 in.

### 316 STAINLESS STEEL CLAMPS

Maximum Torque 75 in.-lbs. (dry)

ENGLISH (inches)				
DESCRIPTION CODE	PART NUMBER	NOMINAL DIAMETER	MINIMUM DIAMETER	MAXIMUM DIAMETER
C410YLW-75-150-S14	941YL-0150	1.50	1.37	1.62
C410YLW-75-200-S14	941YL-0200	2.00	1.87	2.12
C410YLW-75-250-S14	941YL-0250	2.50	2.31	2.62
C410YLW-75-300-S14	941YL-0300	3.00	2.78	3.09
C410YLW-75-350-S14	941YL-0350	3.50	3.28	3.59
C410YLW-75-400-S14	941YL-0400	4.00	3.78	4.09
C410YLW-75-450-S14	941YL-0450	4.50	4.28	4.59
C410YLW-75-500-S14	941YL-0500	5.00	4.78	5.09

METRIC (millimeters)		
NOMINAL DIAMETER	MINIMUM DIAMETER	MAXIMUM DIAMETER
38	35	41
51	47	54
63	58	66
76	70	78
88	83	90
101	96	103
114	108	116
127	121	129



## CLAMPCO

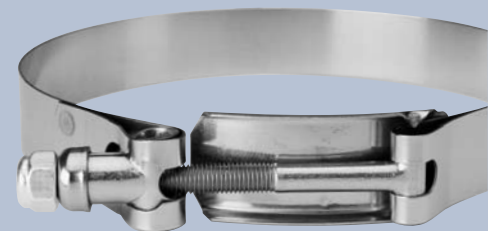

### Custom Order

Clampco is well known for its ability to manufacture custom orders. Some custom orders include different hardware, band thicknesses, and band widths. This picture shows a clamp with a floating bridge under the latch rather than a flat tongue. If you don't see what you need in our catalog, contact our sales department to discuss your special requirements. Custom orders are nothing new to Clampco!

We Customize. Call Today.

# CUSTOM